

PPI applies a wide range of surface treatment technologies for [military](#) and [homeland security](#) applications.

The industry's recent move to lightweight metals such as aluminum, titanium and magnesium, require a variety of surface treatments that PPI provides for numerous customers today.

PPI can accommodate large components, providing everything from conversion coating to finished paint.



Our non-hexavalent chemical conversion (Alodine®) tanks are 132 in. by 72 in. by 96 in. deep.



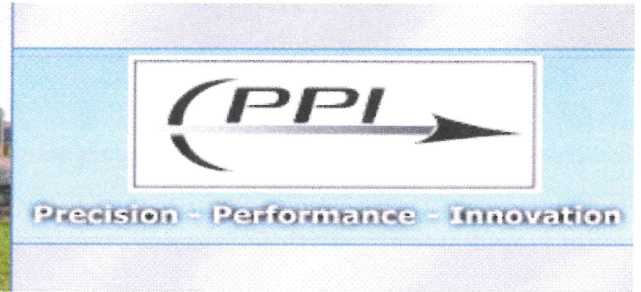

Nadcap™ AC7108 Rev C and AC 7108/1 Rev A approved.

Additional customer specific approvals are updated regularly.

**Cadmium Plating**

- AMS-QQ-P-416
- AMS-2400
- AMS-2401
- QQ-P-416
- Other

**Nickel Plating**

- AMS-QQ-N-290
- AMS-2403
- AMS-2423
- QQ-N-290
- Other

**Chemical Cleaning**

- Ultrasonic
- Vapor Degrease

**Masking**

- Selective Coatings

**Conversion Coating**

- Mil-DTL-5541 Alodine®  
Type I and type II
- Mil-C-5541 Alodine®  
Type I

**Passivation**

- AMS 2700
- AMS-QQ-P-35
- ASTM-A-380
- ASTM-A-967
- QQ-P-35
- Other

**Copper**

- AMS-2418
- Mil-C-14550
- Other

**Electroless Nickel**

- AMS-2404
- AMS-2405
- ASTM-B-733-97
- Mil-C-26074
- Other

**Silver Plating**

- AMS-2410
- AMS-2411
- QQ-S-365
- Other

**Electropolish**

- EPS 15700
- EIS 831

**Paint**

- Mil-C-22750 Epoxy
- Mil-C-53039 CARC
- Mil-DTL-53039 CARC
- Mil-C-85285 Polyurethane
- Mil-PRF-85285
- Mil-P-23377 Epoxy
- Mil-PRF-23377
- Mil-P-53022 Epoxy Prime
- Mil-DTL-53022
- Mil-P-53030
- Mil-F-18264
- Mil-L-46010 Dry Film Lube
- Mil-PRF-46010
- Mil-L-23398





### A Line – Process & Tank Size

- ❖ Vapor Degrease Trichloroethylene
- ❖ Thin Dense Chrome 84X60X36
- ❖ Passivation Non Chrome Nitric 36X60X120
- ❖ Passivation HNO3 Dichromate 58X42X48
- ❖ Copper Strip 36X60X60
- ❖ Sulfamate Nickel 96X60X60

### B Line – Process & Tank Size

- ❖ Soak Clean 72X60X60
- ❖ Electro Clean 96X60X60
- ❖ Woods Ni Strike 47X60X60
- ❖ Cyanide Copper 96X60X60
- ❖ Silver 48X48X48
- ❖ LHE Cadmium 72X60X60
- ❖ Cadmium W Bright 96X60X60
- ❖ Copper Strip 34X60X72

Note; Working space slightly less for heaters and filters

### Groesbeck North - Estimate

- ❖ Shop 26,750 sq. ft. / Office 8,390 sq. ft.
- ❖ Total 35,140 sq. ft.

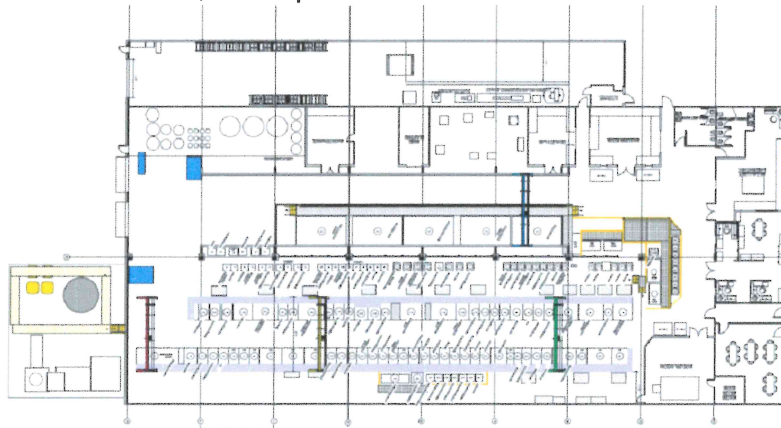

### C Line – Process & Tank Size

- ❖ Sulfamate Ni Strike 36X36X36
- ❖ E Nickel Mid Phosphate 36X36X36
- ❖ Zinc Phosphate 26X34X42
- ❖ Sulfamate Ni Hard 36X36X36
- ❖ Manganese Phosphate 24X24X49
- ❖ White Layer Removal 24X24X36
- ❖ Silver & Nickel Strip 24X24X36

### D Line – Process & Tank Size

- ❖ Alodine™ Hexavalent Conversion 168X108X60
- ❖ Black Oxide 36X36X36
- ❖ Black Oxide XXX
- ❖ Electro Polish XXX

### E Line – Process & Tank Size

- ❖ PTFE Ni 24X24X36
- ❖ E Ni Low Phosphate 24X24X36
- ❖ Development

### F Line – Process & Tank Size

- ❖ Development

### FF Line – Process & Tank Size

- ❖ Alodine™ Non Hexavalent Conversion 132X72X96

### Groesbeck South - Estimate

- ❖ Shop 10,000 / Office 1,600 sq. ft.
- ❖ Total 11,600 sq. ft.

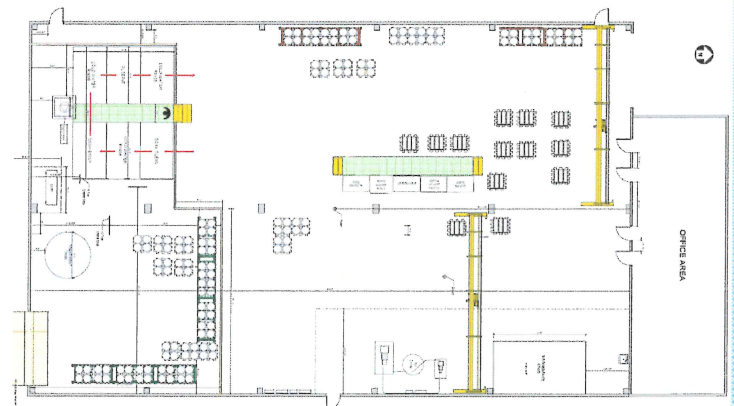

PPI Aerospace Acquisition, LLC





**Hexavalent**  
**Mil-C-5541 Type 1 / DTL 5541 Type 1**  
Class Ia and III  
AMS 2473; 2475; 2475 – ASTM B 499

**Working Dimensions**  
**Width – 96 inches**  
**Length – 156 inches**  
**Depth – 48 inches**  
**Crane – 1 ton**

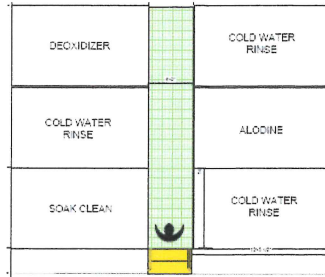

**Non- Hexavalent**  
**Mil DTL 5541 Type 2**  
Class Ia and III

**Working Dimensions**  
**Width – 120 inches**  
**Length – 60 inches**  
**Depth – 84 inches**  
**Crane – 5 ton**